

purple



Owner's Manual

Purple Adjustable Base

Table of Contents

Safety Precautions and Usage Statements 1-4

Parts List..... 5

Base and Remote Overview6

Quick Reference Guide7

Installation Guide8-9

King/Cal King Frame Installation10-11

Headboard Bracket Installation (Not Included) 12

Emergency Battery Backup Strap..... 13

Connecting Strap (Optional) 14

Syncing Two Bases (Split Base Set Up Only) 15

Troubleshooting 16

Safety Precautions and Usage Statements

ATTENTION: IMPORTANT SAFETY DISCLAIMERS

Read the following information before using this product. Failure to use a surge protection device could compromise safety or cause product malfunction and could void the electrical portion of your warranty.

TO REDUCE THE RISK OF SHOCK, BURNS, FIRE OR INJURY

For optimal safety and operation, plug bed base into a surge protector (not included). The bed base should only be plugged directly into a wall outlet or surge protector (strongly recommended). Always unplug the base from the electrical outlet before servicing any part of the base. To reduce risk of electric shock, unplug the base before cleaning. To safely disconnect, ensure the base is in a flat position with all motors off, and unplug from power source. Keep the power cord away from heated surfaces. Never operate the base when the air openings are blocked. Keep air openings free of lint, hair and the like. Do not drop or insert any object into any opening. Discontinue use of the bed base and contact a qualified service center if: it has a damaged cord or plug, if it is not working properly, or it has been dropped into water. Only use this bed base for its intended use as described in this manual. Do not use accessories/ attachments that are not recommended by the manufacturer. Close supervision is required when the bed base is used by or near children, convalescents, disabled persons or pets. Improper connection of the equipment can result in the risk of electrical shock, electrical fire or faulty operation of this bed base. If the plug does not fit your outlet, contact a qualified electrician to install a suitable outlet. Unauthorized modification or failure to use a wall outlet or surge protector could void the electrical portion of your warranty.

SAFETY FEATURES

Manual operation – If something gets caught in the platform when flattened, you can manually raise the platform up by lifting at both

the head and foot to relieve pressure and allow for release.

Emergency stop – Stop the motion of the platform by pressing any button on the remote control.

Power outage – Use the “Emergency Battery Backup Strap” as a temporary power source to get the base to a desired position. Instructions on how to operate the Battery Backup Strap are on the Emergency Battery Backup page(s).

CHILDREN AND PETS

Immediately dispose of all packing materials as it may pose a smothering risk to small children and pets. To avoid injury, it is not advised to allow children and small pets to play on or under the bed. Children should not operate the bed base without adult supervision.

PACEMAKERS

Some products contain Neodymium MAGNETS which may interfere with devices such as pacemakers, ICD's and any other device sensitive to magnetic fields. It is STRONGLY recommended that owners of such medical devices consult their physician prior to using products that contain Neodymium MAGNETS. It is also possible that some pacemakers may falsely interpret the optional massage feature vibrations as movement/exercise. This is a common occurrence with any product that creates a vibrating movement and may affect the pacemaker. Please consult your physician before using the massage feature.

Safety Precautions and Usage Statements

IN-HOME USE AND HOSPITAL STANDARDS

Ergo adjustable bed bases are designed solely for in-home use. This base was not designed as a hospital bed and is not designed to meet hospital standards. Do not use this base with TENT TYPE oxygen therapy equipment or near explosive gases.

ADDITIONAL SAFETY FEATURES

Casters (optional leg accessory) are equipped with locking wheels to prevent unwanted movement. Even when locked and unable to roll, it is possible for the casters to slide. Free release head and foot motors are designed to lower the mattress by retracting only with gravity, never pulling downwards, which minimizes pinch points

LIFTING/LOWERING MECHANISMS

The lift/lower feature will emit a minimal humming sound during operation. This is normal. During operation, the lift arm wheels make contact with the platform support of the base. This contact may result in metal on metal or metal on plastic contact. This applies slight tension on the moving components and resonance is reduced to a minimum level. If excessive noise or vibration is experienced, reverse the movement action (up or down) of the base with the remote control. This should realign the base's activating mechanisms to the proper operational position. In normal base operation, the wheels, which allow the bed to maintain its distance from the wall, will make contact with the steel platform supports of the base creating a contact noise. When entering, exiting or shifting weight on the base, this contact noise may be audible as the wheels make contact. This is normal.

MATERIALS

Ergo adjustable bases are constructed from various materials including woods, metals, plastics and fabrics. Tension, pressure or movement applied to the frame, platform or shroud through general use may create an audible sound.

TOLERANCE

All Ergo adjustable foundations, depending on make and model, are designed and manufactured to perform and function within designated quality control parameters. Bases are subject to meticulous and rigorous inspections during the quality control process to ensure bases will operate within these standards during normal operating use. Normal operating use is defined as the following: Adjustable foundation is to be operated with a mattress and load. Testing procedures require lifetime cycle tests with up to 120kg distributed load. The angle (designated " α " in figure 1) between the back section and the flat section for various configurations of the mattress support platform shall be $\pm 3^\circ$, which translates to a tolerance of up to $1\frac{1}{2}''$.

The angle (designated " β " in figure 1) between the flat section and foot section for various configurations of the mattress support platform shall be $\pm 3^\circ$, which translates to a tolerance of up to $\frac{3}{4}''$.

Any adjustable foundation deemed to be within these allocated tolerances is considered to have met the manufacturer's quality control standards.

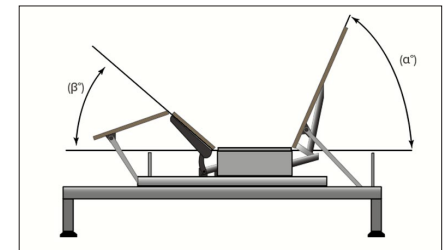

Safety Precautions and Usage Statements

THAT “NEW PRODUCT” SMELL

Some people notice a slight odor to their new adjustable base—this can come from our material manufacturing process. This smell is normal and usually disappears before the product reaches you. Sometimes, however, this smell may still be noticeable. It usually disappears after a few weeks, providing adequate ventilation of the product and the environment.

BREAK IN PERIOD

You can speed up the break-in period by simply spending time in the adjustable bed through activities such as reading, watching TV or playing with the kids or grandkids. The extra movement will help the adjustable base respond to weight and temperature changes. Some of the materials in our adjustable bases such as the woods, metals and plastics used in the platform, frame and components are sensitive to moisture content and temperature and may make sounds in colder environments.

WEAR AND TEAR

Wear and tear is damage that naturally and inevitably occurs as a result of normal use or aging.

FABRIC CARE

To prolong the life of your fabric, protect from direct sunlight whenever possible. For spot cleaning, wipe area with a light damp sponge or vacuum with a soft brush attachment to remove particles. Keep at a minimum of 30cm (12 inches) away from direct heat sources. For a deeper cleaning, blot liquid spills with a clean dry cloth. Wipe with a clean cloth dampened with warm water. Do not wet excessively. A soft bristle brush may be used to remove ingrained

soil. Avoid scratching by gentle brushing. Wipe with a clean cloth dampened with warm water to remove residues. Dry in shade away from direct heat. If persistent marks remain visible after cleaning, seek professional advice.

PRODUCT RATINGS

The lift motors are not designed to operate continuously for more than [2] minutes in an [18] minute time period or approximately 10% duty cycle. Attempting to circumvent or exceed this rating will shorten the life expectancy of the product and may void the warranty. The massage motors are not designed to operate continuously for more than 30 minutes at a time. Please allow the massaging system to rest for 30 minutes after automatic massage shut off before restarting.

WEIGHT LIMITS

This product is not rated to support weights in excess of 750 pounds. The base will structurally support this weight, provided it is evenly distributed across the bed base. The adjustable base is not designed to support or lift this amount in the head or foot sections alone. Exceeding this weight restriction could damage the bed and/or cause injury and will void the warranty.

IMPORTANT DO'S AND DON'TS

DO

- Plug your adjustable base into a power surge protector.
- Evenly distribute weight when sleeping in a split setup. Uneven distribution of weight can cause the base to raise unevenly.
- Call Customer Service for any technical issues. Do not try to force

Safety Precautions and Usage Statements

the base down, this can damage the motors or frame.

- Use mild soap and water to clean your adjustable base if staining occurs.
- Keep in mind that adjustable bases are recommended to be used with adjustable friendly mattresses.
- Lower to the flat (horizontal) position after use.
- Register your warranty as soon as your adjustable base has been delivered.

DON'T

- Sit on corners/edges of base, this may warp the frame, struts or foam.
- Tilt the base on its side. This can damage the legs and/or leg screws.
- Stand or jump on the adjustable base at any time, this can damage the frame and motors.
- Drag the base to move it. Dragging the base could damage the frame, strip the nut/bolts or break the legs. Purchase castors if you plan on moving your base routinely.
- Enter and exit the adjustable base with the head and/or foot in the articulated position. Enter or exit your adjustable in the flat (horizontal) position.
- Tinker with or modify base. This will void the warranty.
- Press down on the head or foot while actuated. This can damage frame and motors.

SAVE THESE INSTRUCTIONS.

FCC Compliance:

NOTE: This equipment has been tested and found to comply with the limits for a Class B digital device, pursuant to part 15 of the FCC Rules. These limits are designed to provide reasonable protection against harmful interference in a residential installation. This equipment generates, uses and can radiate radio frequency energy and, if not installed and used in accordance with the instructions, may cause harmful interference to radio communications. However, there is no guarantee that interference will not occur in a particular installation. If this equipment does cause harmful interference to radio or television reception, which can be determined by turning the equipment off and on, the user is encouraged to try to correct the interference by one or more of the following measures:

- Reorient or relocate the receiving antenna.
- Increase the separation between the equipment and receiver.
- Connect the equipment into an outlet on a circuit different from that to which the receiver is connected.
- Consult the dealer or an experienced radio/TV technician for help.

Parts List

Before discarding the packing materials, ensure all the parts are accounted for. All electronics and components are located in bags under the base or attached to the frame with twist ties or orange zip ties.

- A. Wired Remote Control ①
- B. Mattress Retainer Bar ①*
- C. Legs ⑥
- D. Power Cord ①
- E. Power Supply ①
- F. Battery Backup Strap ①
② 9V Alkaline Batteries (not included)
- G. Connecting Strap ②‡

Optional Item (Not Included):

- H. Sync Cord †

Additional Parts for King/Cal King Install Only:

- I. Long bolts ②
- J. Short bolts ②
- K. Washers ④
- L. Nuts ④
- M. Open end wrenches ②

Headboard Bracket Components (Not Included):

- N. Headboard Bracket ②†
- O. T-Bracket ②†
- P. Long Bolts ③†
- Q. Short Bolts ⑥†
- R. Wingnuts ②†
- S. Washers ②†
- T. Hex Key ①†

- ‡ Only included in Twin Long and Cal King Split bases.
- † This is an optional item and can be purchased.

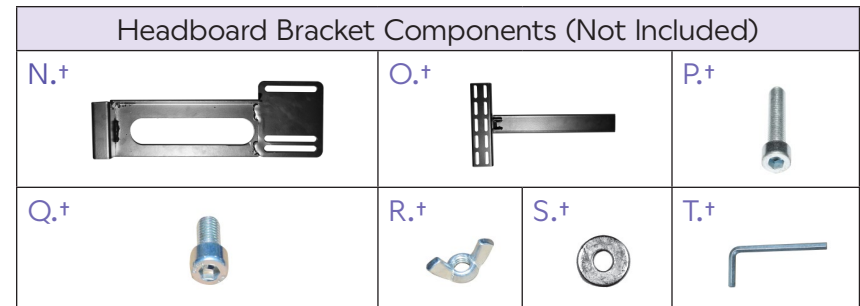
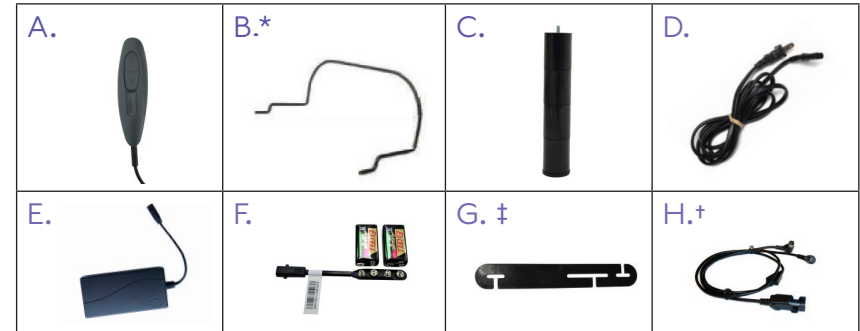

Base and Remote Overview

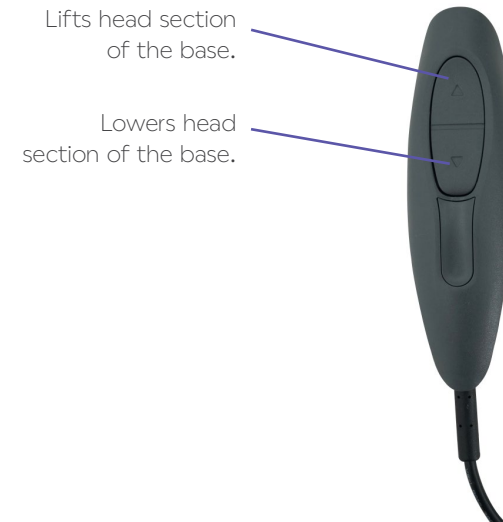

Quick Reference Guide

Not to scale. For illustration purposes only. Read all instructions before beginning installation.

ELECTRONICS OVERVIEW

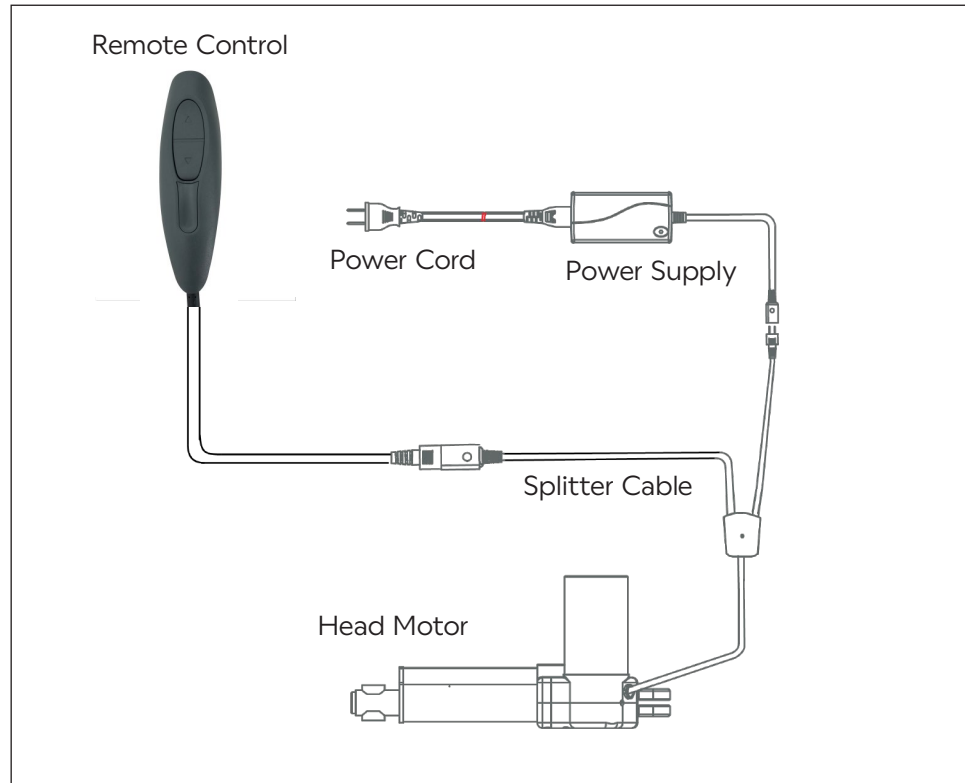

Installation Guide

Always use two people when setting up the base.

STEP 1 - Unfold base

Remove the bed base from the box and unfold keeping the bottom of the base facing upwards.

Remove the binding straps and packing materials, making sure not to puncture the box with any sharp objects.



Base shown in above images is a King size base.

NOTE: For King/Cal King setup, complete Steps 2-3 on pages 10-11 before continuing on the Step 4.

STEP 4 - Install the legs

Legs are shipped fully assembled. Alternative heights in 3" increments can be achieved by removing leg segments.

To install the legs, thread the washer over the bolt of the leg with the recessed side facing the leg, and tighten by hand. **Do not over tighten.**



STEP 5 - Connect head motor cable

Uncoil the Head Motor Cord and plug it into the Power Supply.



Installation Guide

STEP 6 - Attach remote control

Plug the wired remote control into the head motor splitter cable.

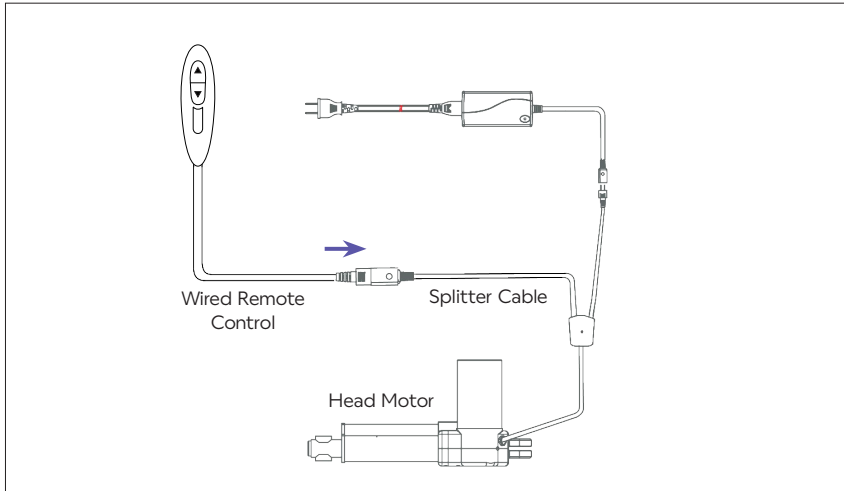

STEP 7 - Flip the base

Carefully flip the base over on to its legs. Important: Two people are required to move the bed base. Do not drag across the floor. Do not rest frame on its side, excessive pressure may damage the legs.

STEP 8 - Install power cord

Insert the Power Cord into the Power Supply.



STEP 9 - Connect to power

Plug the Power Cord into a power outlet. **A surge protector is recommended.**



STEP 10 - Install mattress retainer bar

Place each end of the mattress retainer bar into the inserts at the foot of the base until the retainer bar is secured in place.

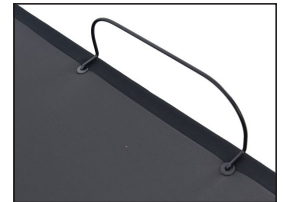

King/Cal King Frame Installation

See page 5 for King/Cal King installation parts.

STEP 2 - Secure hinge with short bolt (K/CK sizes only)

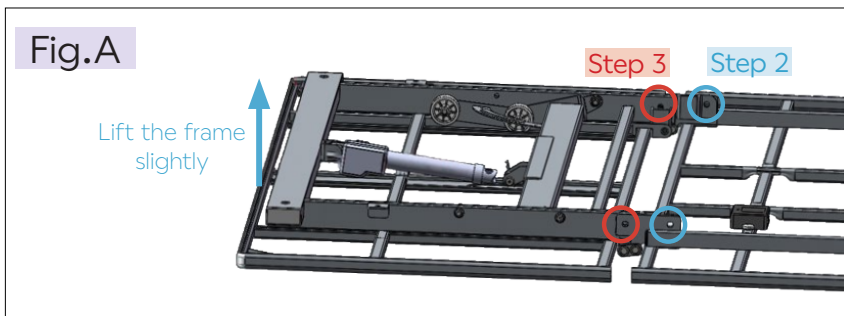

- a. Lift the frame slightly and insert a short bolt through the hole in the hinge of the frame. (Refer to the blue indicators in Fig.A)



- b. If the bolt holes are not aligning, there are two hinge movements that need to be adjusted. Adjust both directions while inserting the bolt to find alignment.

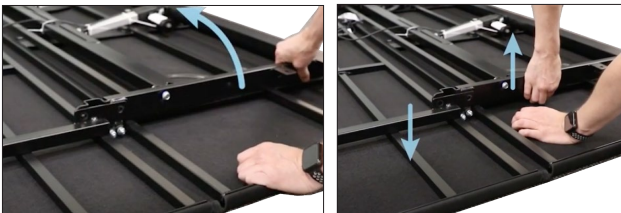

Tips for installing the bolt: To help align the holes, insert a #2 screwdriver through them. Move the screwdriver around while adjusting the hinge to ensure everything lines up perfectly. Inserting packaging foam under one side of the frame can help lift.



- c. Secure the end of the short bolt with a washer and a nut.

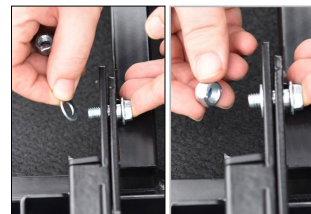

- d. Finger-tighten the bolts first to allow for bolt alignment on both sides before tightening the bolts with the provided open end wrenches.



King/Cal King Frame Installation

STEP 3 - Secure hinge with long bolt (K/CK sizes only)

- a. Lift the frame slightly and insert a long bolt through the hole in the middle of the hinge of the frame. (Refer to the **red** indicators in Fig.A)

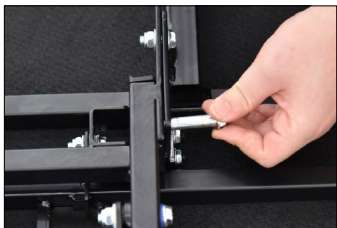

- b. Secure the end of the long bolt with a washer and a nut.

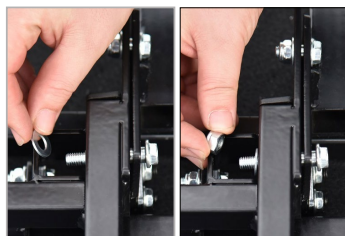

- c. If the bolt holes are not aligning, there are two hinge movements that need to be adjusted. Adjust both directions while inserting the bolt to find alignment.

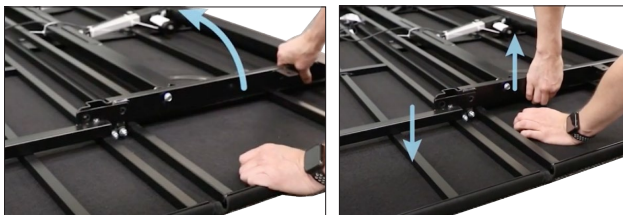

Tips for installing the bolt: To help align the holes, insert a #2 screwdriver through them. Move the screwdriver around while adjusting the hinge to ensure everything lines up perfectly. Inserting packaging foam under one side of the frame can help lift.



- d. Tighten the bolts with the open end wrenches provided.

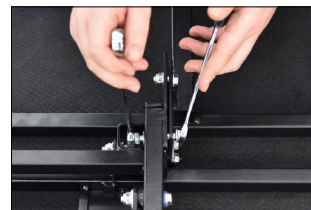

King/Cal frame setup complete.
Please return to Step 4 on page 8 to complete installation.

Headboard Bracket Installation Guide (Not Included)

Headboard Brackets are an optional accessory and are not included.

See page 5 for headboard bracket installation parts list.

STEP 1

- a. Align the hole in the bracket to the nut into which the leg threads. Hold the bracket in place and screw the leg into the base until it is snug. **DO NOT OVERTIGHTEN.** Too much force may cause the leg to spin freely.

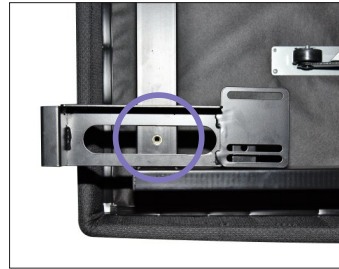

- b. Align the tab with the hole in the frame (located towards the foot of the base) and use a short bolt, washer and wingnut to secure the bracket. Make sure the bolt is tight.

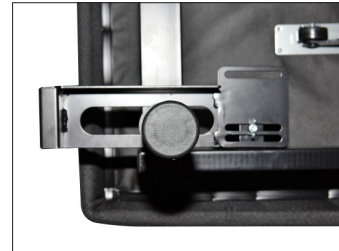

STEP 2

- a. Measure the distance between the mounting holes on the headboard and install the T-Bracket to accommodate the headboard.
- b. To install the T-Bracket, slide the T-Bracket through the end of the headboard bracket. Align the flat side of the T-Bracket plate to the mounting holes on the headboard.
- c. Secure T-Bracket in place by inserting two short screws through top of bracket. Use hex key to tighten screws.

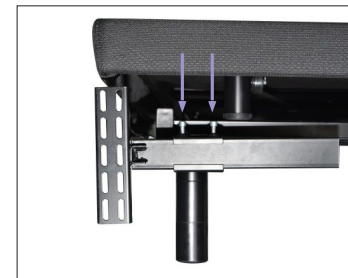
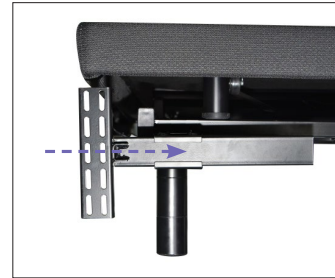

STEP 3

Connect your headboard to the attachment plate using the remaining long screws or hardware that came with your headboard. The heads of the bolts will face outward. Use hex key to tighten bolts.

Emergency Battery Backup Strap

For emergency use only, in case of a power outage.

Batteries are not to be used for normal operation of the bed.

STEP 1

Disconnect the Power Supply from the head motor.

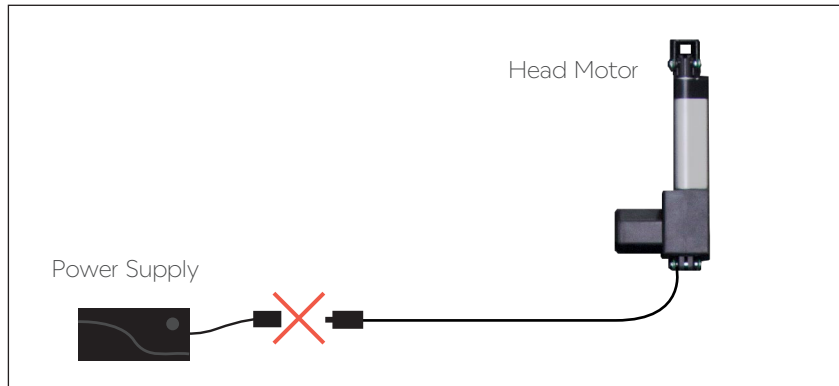

STEP 3

Connect the end of the Battery Backup Strap to the head motor.

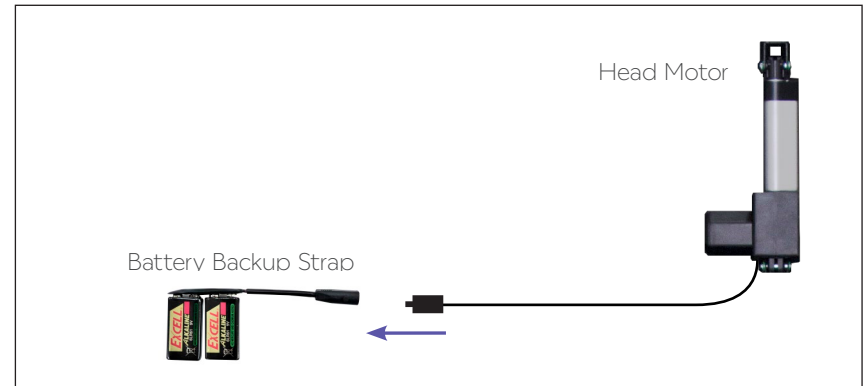

STEP 2

Connect the Battery Backup Strap to the ② Alkaline 9 Volt batteries. Do not mix brand name Batteries.



STEP 4

Use the remote to return the base to a flat position.

Note: Detach the Battery Backup Strap after the emergency is over, as the system will continue to draw power from the batteries even if not in use.

Connecting Strap (Split Base Set Up Only)

If any split setup is being installed, plastic connecting straps are provided (one per base) to secure the bases together. Use both straps to secure the head and foot portions together.

STEP 1

With the bases in their desired location, slightly loosen both legs to allow the strap to fit on the leg bolt, between the leg and frame.



STEP 3

Re-tighten legs. Do not over tighten. Use the remaining strap and repeat on other end of the base.

STEP 2

Slide side (a) of the connecting strap onto leg bolt. Swing the strap and connect side (b) to the leg bolt. Secure the strap by shifting to the left.



Syncing Two Bases (Split Base Set Up Only)

A Sync Cord is an optional accessory (not included) and may be purchased by calling Ergomotion customer service.

The Sync Cord connects the two control boxes to a single remote for the synchronization of two bases.

This process is most commonly used for syncing two connected two TXL bases.

STEP 1

Unplug bases from power source.

STEP 2

Disconnect the remotes on each of the bases. Set one of the remotes aside, it will not be used.

STEP 3

Connect the sync cord to the head motor splitter cable on each base (refer to illustration below).

STEP 4

Plug one of the remotes into the sync cord.

STEP 5

Plug bases back into the power source.

STEP 6

Check to ensure all cords are securely attached. Remote will now operate both bases simultaneously.

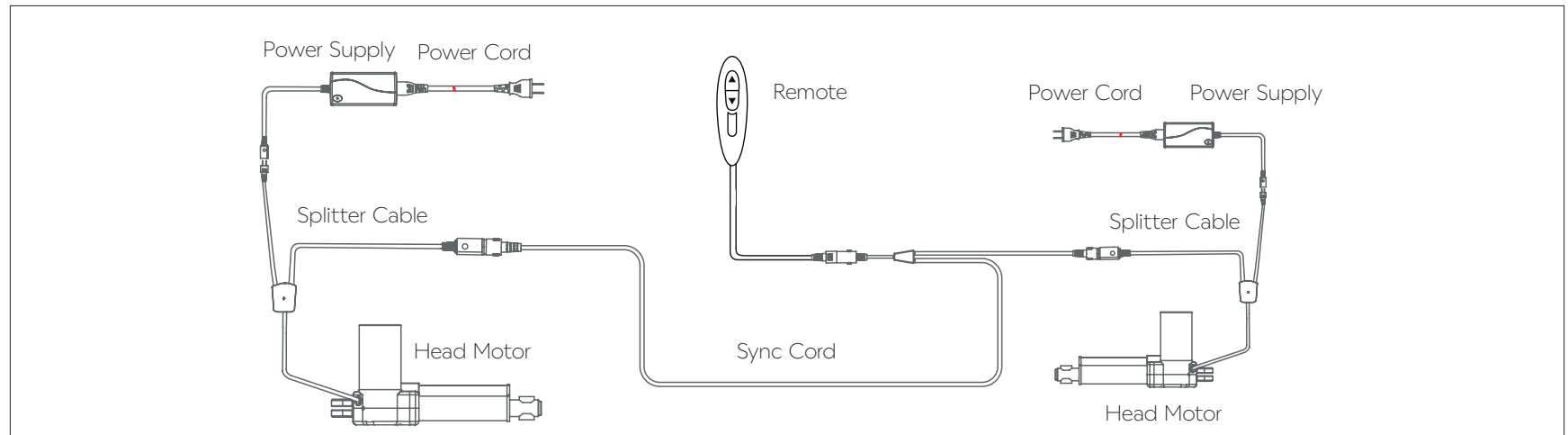

Troubleshooting

If one or more functions on the bed base have stopped operating:

- Check under the bed base to verify that the wired connections are secure and that there are no cords or bedding obstructing the movement of the base.
- Check to ensure the green LED light is illuminated on the power supply. If there is no light, verify that the input and power cords are properly connected.
- Unplug the base for 1 minute to reset the electronic components.
- Plug bed base into a different electrical outlet, or test current outlet with another working appliance (a grounded, electrical surge protector is recommended).

If issue is not resolved by following the instructions above, locate serial number on warranty card and call

Ergomotion Customer Service: US 1-888-550-3746

Notes

Nationwide Customer Service

Phone 1.888.550.3746
Fax 1.805.979.9399
Email info@ergomotion.com
Web www.ergomotion.com

Serial Number:

+	+
+	+